



REPLACEMENT PARTS

Distributor net price list

(Effective March 24, 2026)

Please ensure to check for the latest revision to the Wholesale book

***Heating, Ventilation, Refrigeration
and Air Conditioning Parts***

C O N F I D E N T I A L

Airdex Corporation

**230 Saunders Rd
Barrie ON L4N 9A2
Canada**

**Tel. 705-739-8882
Toll free 877-739-8884
sales@airdexp.com
www.airdexp.com**

Table of Contents

Terms and Conditions of Sale	3
N – Series assembled fans, 3 blades	4
N – Series assembled fans, 4 blades	5
N – Series assembled fans, 4 blades	6
Universal Hubs.....	7
One piece series, 4 and 5 blades	8
One piece series, 5 blades	8
AA Series – Airotor wheels.....	9
AD Series – Airotor wheels	10
AMU Series – Air Make-Up Units	11
Miscellaneous Replacement Blowers	12
Furnace Blowers – Belt Drive.....	13
Furnace Blower Wheels – Belt Drive	13
Furnace Blowers – Direct Drive.....	14
Furnace Blower Wheels – Direct Drive.....	14
Motor mount brackets - Direct Drive.....	15
Blower shafts Ø3/4.....	15
Miscellaneous Replacement Parts	15

Terms and Conditions of Sale

TERMS of SALE

- All shipments are F.O.B. Barrie Ontario.
- Payment terms are Net 30 Days.
- Minimum order amount is \$50.00.
- Prices are subject to change without notice.
- (See Invoice for complete "Conditions of Sale").
- Lead Time 4-6 weeks (may be affected if purchased items are needed)

Warranty

Airdex Corporation products are guaranteed for a period of one year from date of sale against manufacturing defects in material and workmanship under normal operating conditions. Liability is limited to the replacement of defective parts. Labour and freight costs are not included. (See Invoice for complete "Conditions of Warranty").

Returned Goods

- Damage claims should be made upon receipt and to the carrier of the shipment. Airdex Corporation is not responsible for damage in transit.
- No returns will be accepted without prior authorization from Airdex Corporation. Return shipping documents must indicate the R.G. No. (Return Goods Number) or they will be refused.
- Items returned for "Re-Stocking" will be subject to a 25% Re-Stocking charge.

(TERMCOND.497)

N – Series assembled fans, 3 blades

Regular duty condenser type – Less Hub

Applications: - Unitary Air Conditioning, Heat Pumps and Ventilating

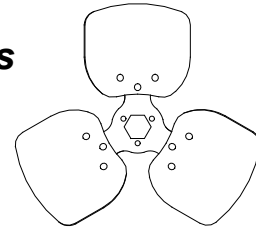

CW part #	CCW part #	Dia. Inches	Pitch Degrees	Blade depth Inches	Price Each	
					1-40 pcs	41-80 pcs
2770202	2770212	12	16	1.81	15.95	14.97
2770952	2770962	12	23	2.49	15.95	14.97
2770242	2770252	14	19	2.45	19.00	17.56
2771502	2771442	14	23	2.87	19.00	17.56
2771522	2771432	14	27	3.28	19.00	17.56
2770072	2770082	14	32	3.75	19.00	17.56
2771542	2771532	16	19	2.90	22.19	20.55
2770302	2770312	16	22	3.26	22.19	20.55
2771552	2771562	16	27	3.84	22.19	20.55
2770132	2770142	16	29	4.06	22.19	20.55
2770572	2770862	18	20	3.30	30.99	28.64
2770972	2770982	18	23	3.70	30.99	28.64
2770362	2770372	18	27	4.24	30.99	28.64
2770402	2770412	20	16	3.01	36.99	34.25
2771572	2771422	20	23	4.09	36.99	34.25
2770422	2770432	20	24	4.24	36.99	34.25
2771592	2771582	20	27	4.69	36.99	34.25
2771612	2771712	20	33	5.51	36.99	34.25
2771362	2771372	22	27	5.10	39.22	36.81
2771262	2771272	22	33	6.03	39.22	36.81
2771622	2771402	24	18	4.15	42.42	39.81
2771282	2771292	24	27	5.73	42.42	39.81
2771382	2771392	24	33	6.70	42.42	39.81
2771322	2771332	26	27	5.80	50.92	49.35
2771342	2771352	26	33	6.80	50.92	49.35

Packed 4 per carton – not broken

For Larger volume please call for quote

N – Series assembled fans, 4 blades

Regular duty condenser type – Less Hub

Applications: - Unitary Air Conditioning, Heat Pumps and Ventilating

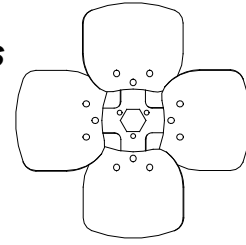

CW part #	CCW part #	Dia. <i>Inches</i>	Pitch <i>Degrees</i>	Blade depth <i>Inches</i>	Price Each	
					1-40 <i>pcs</i>	41-80 <i>pcs</i>
2771632	2771002	10	19	1.75	17.36	16.17
2770582	2770592	10	23	2.04	17.36	16.17
2770602	2770612	10	27	2.33	17.36	16.17
2770622	2770632	10	33	2.74	17.36	16.17
2770702	2770712	12	23	2.49	17.71	16.49
2770542	2770552	12	26	2.76	17.71	16.49
2770222	2770232	12	33	3.32	17.71	16.49
2770722	2770732	14	23	2.87	22.28	21.03
2770282	2770292	14	26	3.17	22.28	21.03
2770262	2770272	14	33	3.87	22.28	21.03
2771652	2771022	16	19	2.90	25.26	23.70
2770742	2770752	16	23	3.38	25.26	23.70
2770322	2770332	16	26	3.72	25.26	23.70
2770342	2770352	16	33	4.50	25.26	23.70
2770382	2770392	18	24	3.84	38.34	35.98
2770762	2770772	18	27	4.24	38.34	35.98
2771672	2771662	18	30	4.61	38.34	35.98
2770642	2770652	18	33	4.99	38.34	35.98
2770462	2770472	20	23	1.09	45.61	42.81
2771692	2771682	20	27	4.69	45.61	42.81
2770482	2770492	20	29	4.98	45.61	42.81
2770662	2770672	20	33	5.51	45.61	42.81

Packed 4 per carton – not broken
For Larger volume please call for quote

N – Series assembled fans, 4 blades

Heavy duty condenser type – Less Hub

Applications: - Unitary Air Conditioning, Heat Pumps and Ventilating

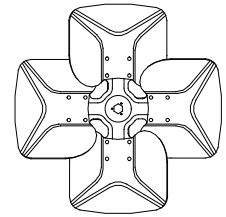

CW part #	CCW part #	Dia. Inches	Pitch Degrees	Blade depth Inches	Price Each	
					1-40 pcs	41-80 pcs
2771032	2771042	22	23	4.48	46.20	44.32
2771052	2771062	22	27	5.10	46.20	44.32
2771072	2771082	22	33	6.03	46.20	44.32
2771702	2771222	24	18	4.15	48.01	46.09
2771092	2771102	24	23	5.03	48.01	46.09
2771112	2771122	24	27	5.73	48.01	46.09
2771132	2771142	24	33	6.70	48.01	46.09
2771152	2771242	26	23	5.12	56.46	54.20
2771172	2771182	26	27	5.80	56.46	54.20
2771192	2771202	26	33	6.80	56.46	54.20

Packed 4 per carton – not broken

For Larger volume please call for quote

S – Series assembled fans, 4 blades

Heavy duty condenser type – Ø5/8" hub, Keyway, 2 setscrews

Applications: - Unitary Air Conditioning, Heat Pumps and Ventilating

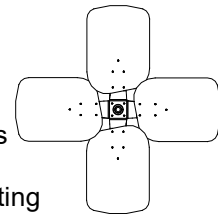

CW part #	Dia. Inches	Pitch Degrees	Blade depth Inches	Price Each	
				1-40 pcs	41-80 pcs
2771212	30	22	4.06	79.82	77.16
2771232	30	28	4.91	79.82	77.16

Packed 4 per carton – not broken

For Larger volume please call for quote

Universal Hubs

Hex Head design
 Attaches on either Intake or Discharge side.
 Mounting screws included.
 Protective coating
 Keyway on Ø5/8" bore.

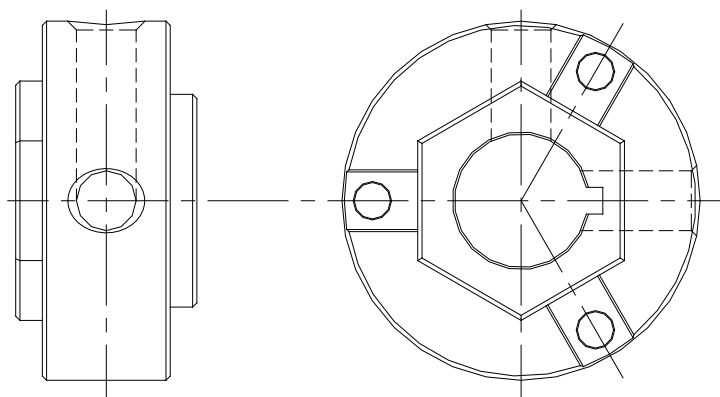

Part #	Bore size Inches	Keyway	Price
2038052	5/16	no	174.24 / CTN 12
2038062	3/8	no	174.24 / CTN 12
2038072	1/2	no	174.24 / CTN 12
2038082	5/8	Yes	174.24 / CTN 12

Packed 12 per carton – not broken

We are developing new Universal Hub(s), Airdex branded. Once these hubs are completed. We will then amend the Wholesale book to reflect the new pricing. The new Hub(s) will allow us to offer at a better pricing than current.

One-piece series, 4 and 5 blades

Axial flow fan

Applications: - Unitary Air Conditioning, Heat Pumps and Ventilating

CW part #	CCW part #	Dia. Inches	Pitch Degrees	Bore size Inches	Price each	
					1-30 pcs	40-80 pcs
1010702	1010712	5	27	1/4	4.53	4.21
1010722	1010732	5	27	5/16	4.53	4.21
1010802	1010822	6	20	1/4	4.40	4.12
1010852	1010842	6	30	1/4	4.40	4.12
1010352	1010632	8	24	1/4	5.24	4.87
1010642	1010652	8	24	5/16	5.74	5.37
1010662	1010672	10	31	1/4	7.20	6.70
1010362	1010692	10	31	5/16	7.70	7.20
1010042	1010052	12	24	5/16	13.88	13.38
1010012	1010062	12	28	5/16	13.88	13.38

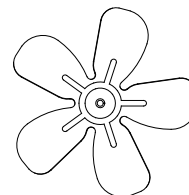

5" – 10" dia.

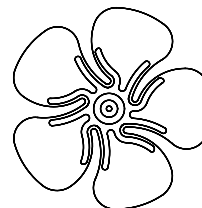

12" dia.

**Packed 10 per carton – not broken.
For Larger volume please call for quote**

One-piece series, 5 blades

Axial flow fan – Holes pattern to fit Unit Bearing Motor

Applications: - Unitary Air Conditioning, Heat Pumps and Ventilating

CW part #	CCW part #	Dia. Inches	Pitch Degrees	Hole pattern	Price each	
					1-30 pcs	40-80 pcs
1010402	1010462	6	31	yes	3.74	3.60
1010412	1010472	7	31	yes	4.95	4.77
1010432	1010492	8	31	yes	5.24	4.89
1010452	1010512	9	31	yes	6.84	6.58
1010442	1010502	10	31	yes	7.66	7.37

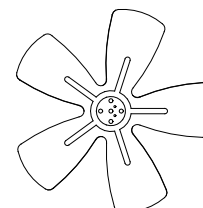

6" – 10" dia.

**Packed 10 per carton – not broken.
For Larger volume please call for quote**

AA Series – Airotor wheels

Single inlet centrifugal wheel
 Trued and Dynamically Balanced
 Steel with corrosion resistant finish
 (Aluminum wheels available – contact sales for pricing)

Applications: - Room Air Conditioning, Fan Coil Units, Fireplace blowers, Range Hoods, Power Burners

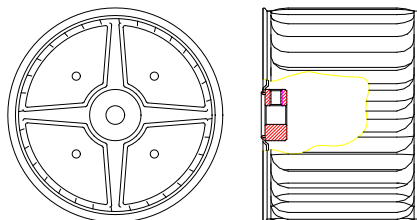

Note: Rotation determined by viewing backplate

CW part #	CCW part #	Dia. Inches	Width Inches	Bore Size Inches	Airdex Code	Price Each
4705952	4705962	5.25	2.5	5/16	508-216	19.01
4705972	4705982	5.25	3	5/16	508-229	19.39
4705992	4706002	5.25	3.5	5/16	508-316	21.18
4706012	4706022	5.75	3	5/16	524-229	21.70
4706032	4706042	5.75	3.5	5/16	524-316	21.93
4706052	4706062	5.75	4	1/2	524-400	21.96
4706072	4706082	6.3125	3.75	1/2	610-325	22.18
4706092	4706102	6.3125	4.25	1/2	610-408	23.03

For Larger volume please call for quote

AD Series – Airotor wheels

Double inlet centrifugal wheel
 Trued and Dynamically Balanced
 Steel with corrosion resistant finish
 (Aluminum wheels available – contact sales for pricing)

Applications: - Condensers, Fan Coil Units, Small Appliances, Furnaces

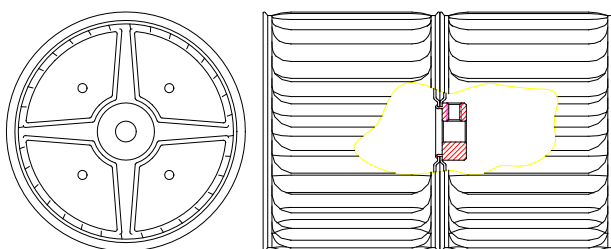

Note: Rotation determined by viewing hub

CW part #	CCW part #	Dia. Inches	Width Inches	Bore Size Inches	Airdex Code	Price Each
4705632	4705642	5.25	7	1/2	508-316	27.58
4705652	4705662	5.75	7.5	1/2	524-400-316	28.33
4705672	4705792	5.75	7.75	1/2	524-408-316	28.52
4705812	4705802	5.75	8	1/2	524-408-325	28.99
4705702	4705712	6 5/16	7	1/2	610-314	30.21
4705722	4705732	6 5/16	7.5	1/2	610-400-314	30.60
4705822	4705742	6 5/16	7.75	1/2	610-408-314	30.71

For Larger volume please call for quote

AMU Series – Air Make-Up Units

Available in wide range of sizes
 Forward curved single or double inlet wheels
 Suitable for Unitary Air Conditioning applications, Heat pumps and Ventilating

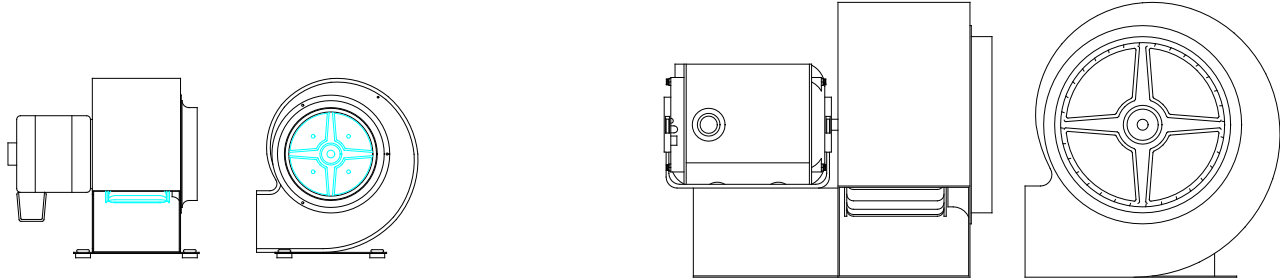

AMU 75 – AMU 400

AMU 525 – AMU 625

Model	Part #	Air flow cfm	Motor hp	Price Each	
				1-9 pcs	10+ pcs
AMU75	7017010	75	1/60	189.61	182.02
AMU130	7017560	130	1/70	176.43	169.37
AMU245	7017550	245	1/30	186.39	178.94
AMU400-R	7816445	400	1/12	325.11	312.10
AMU400-E	7017450	400	1/12	266.97	256.29
AMU525	7017470	625	1/4	357.19	342.91
AMU625	7017480	625	1/4	363.23	348.71

Packed 1 per carton

For Larger volume please call for quote

Model	Part #	Replacement wheel		Replacement motor	
		Part #	Price each	Part #	Price each
AMU75	7017010	4015201	39.87	7629231	125.53
AMU130	7017560	4015011	23.60	7627351	115.16
AMU245	7017550	4015022	13.05	7627341	127.65
AMU400	7816445	4015062	14.01	7627171	243.80
AMU400	7017450	4015062	14.01	7627071	168.75
AMU525	7017470	4015071	43.16	7627141	248.87
AMU625	7017480	4015081	49.86	7627141	248.87

Packed 1 per carton

Miscellaneous Replacement Blowers

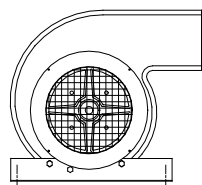

Dock Seal Blower

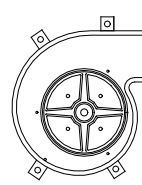
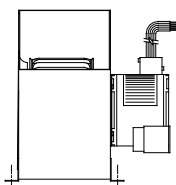

Draft Inducer

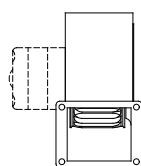
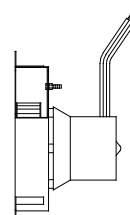

7017340 (Dayton #4C458)

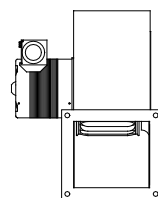
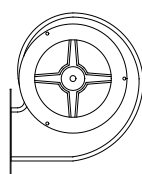

7017300 (Dayton #4C447)

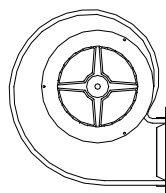
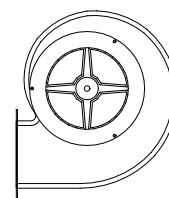

7017460 (Ref: Dayton #4C448)

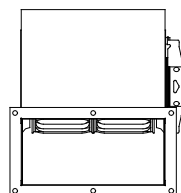

Part #	Description	Price each	Replacement wheel		Replacement motor	
			Part #	Price each	Part #	Price each
7815200	Dock Seal Blower SC-800-4496	378.26	4819745	69.16	7627901	205.55
7815610	Draft Inducer SC-416-4355	156.31	4015441	23.99	7627601	89.06
7017420	Blower 160cfm w/ flange (Ref.Dayton#4C458)	136.10	4818181	17.05	7629051	90.72
7017440	Blower 265cfm w/ flange (Ref.Dayton#4C447)	163.13	4818181	17.05	7627211	111.32
7017460	Blower 465cfm w/ flange (Ref.Dayton#4C448)	187.91	4825211	19.50	7627201	123.70
7815600	Blower SC-408-4245	204.78	4015691	43.47	7627661	95.65

Packed 1 per carton

For Larger volume please call for quote

Furnace Blowers – Belt Drive

Available in wide range of sizes
 Forward curved double inlet centrifugal wheels
 Housing supports, motor mounting bracket and hardware are included
 Motor and drive package are not included

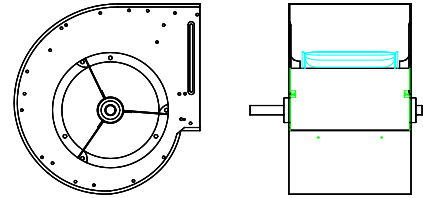

Also available in twin blower configuration – please inquire

Model	Shaft dia. Inches	Sleeve Bearings		Ball Bearings	
		Part #	Price each	Part #	Price each
G9-7	3/4	6010332	155.08	6010402	191.48
G9	3/4	6010342	166.97	6010412	204.62
G10-8	3/4	6010372	190.20	6010442	220.35
G10	3/4	6010212	204.42	6010352	227.20
G12-9	3/4	6010282	388.01	n/a	-
G12	3/4	6010272	363.29	6010262	401.20
G15	1	n/a	-	6010172	1064.06
G18	1	n/a	-	6010182	1618.03

Packed 1 per carton

For Larger volume please call for quote

Furnace Blower Wheels – Belt Drive

Available in wide range of sizes
 Forward curved double inlet centrifugal wheels
 Trued and Dynamically Balanced

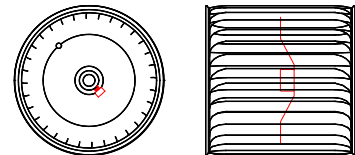

Part #	Bore size Inches	Wheel dia. Inches	Wheel width Inches	Price Each
5014652	3/4	9 1/2	7 1/8	47.81
5014662	3/4	9 1/2	9 1/2	53.73
5014672	3/4	10 5/8	8	50.80
5014682	3/4	10 5/8	10 5/8	52.52
5705452	3/4	12 5/8	12 5/8	155.25
5705462	3/4	12 5/8	9 1/2	194.17
5705482	1	15	15 1/2	391.21

Packed 1 per carton

Furnace Blowers – Direct Drive

Available in wide range of sizes
 Forward curved double inlet centrifugal wheels
 Housing supports and hardware are included
 Motor mount bracket is available

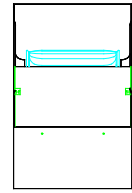
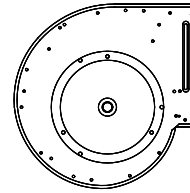

Model	Part #	Price each	Model	Part #	Price each
DC916-416	6010392	89.17	DCT916-416	6010152	82.47
DC916-600	6010382	92.21	DCT916-600	6010162	84.81
DC916-704	6010422	96.04	DCT916-704	6010232	93.07
DC916-916	6010142	100.23	DCT916-916	6010462	95.26
DC1020-800	6010362	108.52	DCT1020-800	6010542	106.13
DC1020-1020	6010312	111.29	DCT1020-1020	6010562	107.48
DC1220-916	6010292	274.02	DCT1220-1104	6010572	286.64

Packed 1 per carton

Other sizes available upon request / For Larger volume please call for quote

Furnace Blower Wheels – Direct Drive

Available in wide range of sizes
 Forward curved double inlet centrifugal wheels
 Trued and Dynamically Balanced

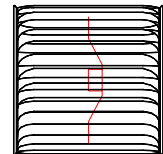
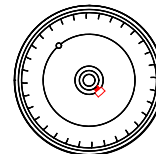

Model	Part #	Bore size Inches	Wheel dia. Inches	Wheel width Inches	Price each
CM916-416	5705492	1/2	9 1/2	4 1/2	43.42
CM916-600	5705502	1/2	9 1/2	6	44.54
CM916-704	5705412	1/2	9 1/2	7 1/8	45.08
CM916-916	5705422	1/2	9 1/2	9 1/2	50.19
CM1020-800	5705432	1/2	10 5/8	8	47.84
CM1020-1020	5705442	1/2	10 5/8	10 5/8	48.57
CM1220-916	5014961	1/2	12 5/8	9 1/2	160.24
CM1220-1104	5015001	1/2	12 5/8	11 1/8	142.35

Packed 1 per carton

Other sizes available upon request / For Larger volume please call for quote

Motor mount brackets - Direct Drive

Part #	Description	Price each
6619051	9" Belly Band Motor mounting assembly	17.90
6619061	10" Belly Band Motor mounting assembly	17.96
6619071	12" Belly Band Motor mounting assembly	21.39

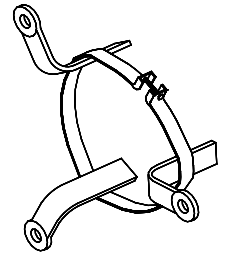

Packed 1 per carton

Blower shafts Ø3/4

Part #	Shaft length Inches	Price each
6527032	10	11.11
6527042	12	12.60
6527052	14	14.05
6527062	16	15.47
6527112	16 5/8	15.99
6527072	18	17.04
6527082	20	18.46
6527092	22	18.83
6527102	24	21.15



Packed 6 per carton – Not broken

Miscellaneous Replacement Parts

Part #	Description	Price each
9967862	Bearing Pack - 2 Sets of Bearings, Collars & Washers (2x3/4)	44.27
6969002	Ball Bearing Pack - 2 Sets of Bearings & Grommets (2x3/4)	73.11
6959002	Motor Adjusting Leg	6.45

For Larger volume please call for quote