

Features:

- Ball bearings
- Large Access panels for ease of installation and service
- Insulated
- Grey enamel finish on galvanized steel
- 2 motor mounting brackets
- Filter sections available separately

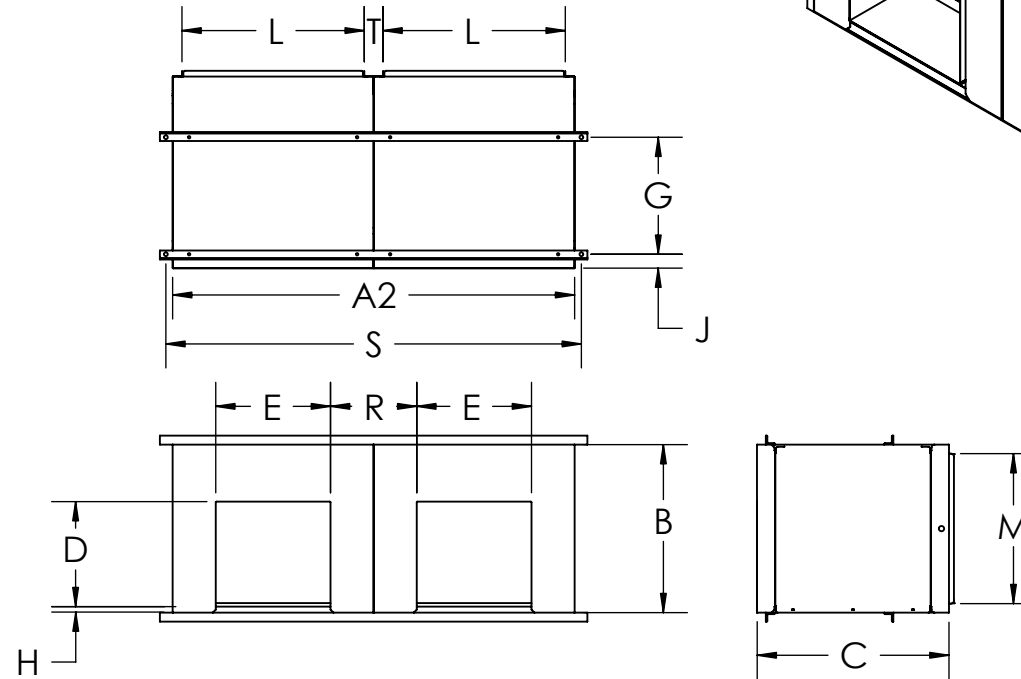
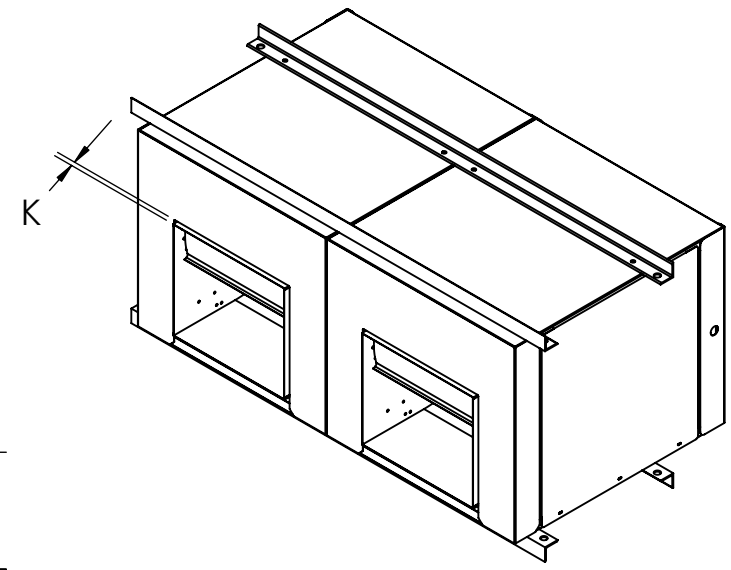

BOM#	Model	A2	B	C	D	E	G	H	J	K	L	M	R	S	T
8887335	DB-207-2	36	15-3/8	23	10-1/4	9-3/16	9-5/8	1	1-3/4	5/16	15-7/8	13-3/8	8-13/16	38-1/4	2
8887345	DB-209-2	42	18	23	10-1/4	11-13/16	11-3/4	1	1-3/4	5/16	19	16	9-3/16	44-1/4	2
8887355	DB-210-2	44-1/2	20	24-3/4	11-3/8	13-1/8	13-3/8	1	2-1/4	5/16	20-1/4	18	9-1/8	46-3/4	2
8887365	DB-212-2	54	23	27-1/2	13-7/16	15-5/8	16-1/8	1	2-5/16	5/16	25	21	11-3/8	56-1/4	2
8887315	DB-215-2	67	28	32	15-7/8	18-5/8	19-1/2	1	2-5/16	5/16	30-1/2	25	14-7/8	69-1/4	3
8887325	DB-218-2	83	34	44	18-7/8	21-7/8	24	2	3-3/16	1/2	35-3/8	31-5/8	19-5/8	85-1/4	6.25

Blower data							Motor data						Pulleys		Belt
Fan #	Qty	Model	Air flow (CFM)	SP	Power (HP)	RPM	Power (HP)	Frame size	Volts	Hz	PH	RPM	Blower	Motor	Length
Airflow in:					Project:						AIRDEX CORPORATION, BARRIE, ONTARIO 200-2 Series Imperial submittal drawing				
Static pressure in:					Contractor:										
Velocity in:					Supplier:										
Motor power in:					Engineer:						Date submitted:				